

Sponsorship and Exhibition Prospectus

SMART GREEN ENERGY FOR FUTURE ICT

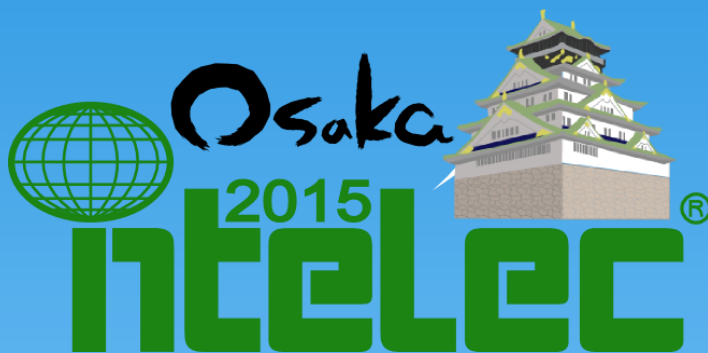

18 – 22 October, 2015

Swissôtel NANKAI OSAKA

Namba, Osaka, Japan

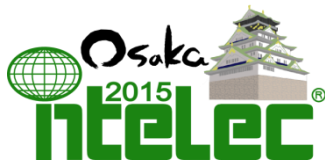

SMART GREEN ENERGY FOR FUTURE ICT

Swiss Hotel Nankai, Namba, Osaka, Japan

18 – 22 October, 2015 <http://www.intelec2015.org/>

General Chairs' Welcome Message

Committee Members

General Chair

Mr. Kiyoshi Tsutsui
President and CEO,
NTT Facilities, Japan

General Co-Chair

Dr. Tadahito Aoki
Senior Vice President,
NTT Facilities, Japan

Organizing Committee Chair

Prof. Fujio Kurokawa
Nagasaki Univ., Japan

Vice-Chairs

Dr. John Hawkins
Telepower Australia Pty Ltd.,
Australia

Prof. İlhami Colak
Gazi Univ., Turkey

Technical Program Committee Chair

Prof. Masahito Shoyama
Kyushu Univ., Japan

Vice-Chairs

Dr. Keiichi Hirose
NTT Facilities, Japan

Prof. Alexis Kwasinski
Univ. of Texas, USA

Secretary

Prof. Tadashi Suetsugu
Fukuoka Univ., Japan

It is my great pleasure to welcome you to the 37th IEEE PELS International Telecommunications Energy Conference (INTELEC) 2015. It is indeed my honor to serve as the General Chair of this conference, which is being organized at Osaka City, Japan during October 18-22, 2015.

This exciting conference program will include a key note session from today's industry leaders as well as technical presentations, continuing educations tutorials, workshops, poster sessions, and exhibition. Every effort has been made to create a program that has a significant component of industry and business to encourage dialogue with the academic community. The topics in this conference cover all aspects of "Smart Green Energy for Future ICT", with papers or presentations on the latest happenings in those fields.

During the conference, we provide ample opportunities for networking with attendees from various parts of the world. We encourage you to enjoy these organized events while venturing further in Osaka.

I would like to acknowledge the IEEE Power electronics Society (PELS) for their great partnership in sponsoring the INTELEC 2015. I feel deeply grateful to all the people that have contributed to make this event possible. Thanks are also extended to the conference administrative committee, the volunteers, and supporters, for their tirelessly efforts throughout the course of the conference.

Finally, I wish all the participants a very fruitful and productive conference, and also an unforgettable stay in Osaka where you will find the perfect blend of cultures, the modern and the traditional, and the oriental.

On behalf of the INTELEC 2015 Steering Committee we are look forward to seeing you and extending our hands for a warm welcome!

Kiyoshi Tsutsui
President and CEO, NTT FACILITIES, INC.
General Chair, INTELEC 2015

INTELEC2015 Sponsorship and Exhibition Prospectus

Conference:	37th IEEE International Telecommunication Energy Conference INTELEC2015	www.intelec2015.org/
Date:	October 18- 22, 2015	
Venue:	Swissôtel NANKAI OSAKA	www.swissotel.com/hotels/nankai-osaka/
Number of Participants:	Approx. 800 participants (Domestic: 450 / Overseas: 350)	
Number of Papers:	Approx. 350 papers	

Smart Green Energy for Future ICT

INTELEC®, International Telecommunications Energy Conference, is the annual world-class technical forum presenting the latest in communications power systems, energy storage and energy conversion. This year's exciting conference program will include key note and plenary sessions from today's industry leaders as well as technical presentations, continuing educations tutorials and workshops and poster sessions. This leading conference will also include a comprehensive technical tour and social program for networking amongst industry peers.

Scope of the Conference

The scope of the conference will include but not limited to the following communications power and energy system topics:

Communications Power Systems

- Outside plant power systems (twisted pair, customer premises, etc.)
- Renewable energy generations (Wind, PV, Hybrid, etc.)
- Islanded and grid-connected autonomous power systems
- Power systems (High and/or low voltage DC; High and/or low voltage AC) for central offices/data centers
- Power distribution architectures for communications equipment
- Wireless power transfer for handheld communications devices

Energy Storage for Communications Systems

- Architectures for energy storage
- Battery technology (lead, zinc, lithium, sodium, etc.)
- Flow battery technology
- New fuel cell technology
- Energy management techniques
- Energy modeling and simulation

Power Conversion for Communications Equipment

- Circuit Topologies and control techniques for AC/DC, DC/DC and DC/AC power converters
- Utility interface inverters for energy generation and storage
- AC and DC UPS
- High efficiency and high density power supplies

Site Support Systems

- Disaster recovery and mitigation
- Engine generator technology
- Physical and thermal design
- Grounding and EMC
- Codes, standards, and specifications

INTELEC2015 Sponsorship

Package Sponsor

Diamond – JPY 5,000,000-

- First selection of exhibition booth
- Exhibition booth (16 sq.m.= width 4 meters x depth 4 meters)
- Five full conference registrations
- Five exhibitor badges
- One exhibitor seminar session
- Company logo and link on INTELEC website
- Signage displaying Diamond status throughout the conference
- Company logo on conference bag
- Full page color advertisement and company logo in program booklet
- One piece of company literature in conference bag
- Company logo on USB drives containing conference proceedings
- Reserved table at the banquet
- Mentioned as the Diamond Sponsor at the Opening Keynote Plenary Session and Banquet

Gold – JPY 3,000,000-

- Exhibition booth (12 sq.m.= width 6 meters x depth 2 meters)
- Three full conference registrations
- Five exhibitor badges
- One exhibitor seminar session
- Company logo and link on INTELEC website
- Signage displaying Gold status throughout the conference
- Company logo on conference bag
- Full page color advertisement and company logo in program booklet
- One piece of company literature in conference bag
- Reserved table at the banquet

Silver – JPY 2,000,000-

- Exhibition booth (8 sq.m.= width 4 meters x depth 2 meters)
- Two full conference registrations
- Three exhibitor badges
- Company logo and link on INTELEC website
- Signage displaying Silver status throughout the conference
- Full page black & white advertisement and company logo in program booklet
- One piece of company literature in conference bag

Bronze – JPY 1,000,000-

- Exhibition booth (4 sq.m.= width 2 meters x depth 2 meters)
- One full conference registrations
- Two exhibitor badges
- Company logo and link on INTELEC website
- Signage displaying Bronze status throughout the conference
- Half page black & white advertisement and company logo in program booklet

Other Marketing Opportunities

Advertisement on Program Booklet

A-5 Size				
Back cover	Color	Full page	JPY 500,000	(one company)
Inside cover	Color	Full page	JPY 350,000	(one company)
Back matter	Color	Full page	JPY 250,000	(no limit)
Back matter	B&W	Full page	JPY 200,000	(no limit)

Coffee Break

**There will be your advertising display during break time.
JPY 200,000 / 1 break**

Insert in Conference Bag

It is possible for you to put novelty goods or literature in conference bag.
JPY 200,000 / 1 item

Name Badge Straps

Limited to TWO companies
Logo to be printed on the straps of the name badges for all delegates
JPY 250,000

INTELEC2015 Exhibition

Exhibition Fee: **JPY 350,000** / 1 booth: 4sq.m (Width 2m × Depth 2m)
on or before **31st May, 2015**

Application	Fee
On or Before May 31, 2015	JPY 350,000
After June 1, 2015	JPY 400,000
Application Deadline:	June 30, 2015

Package Booth

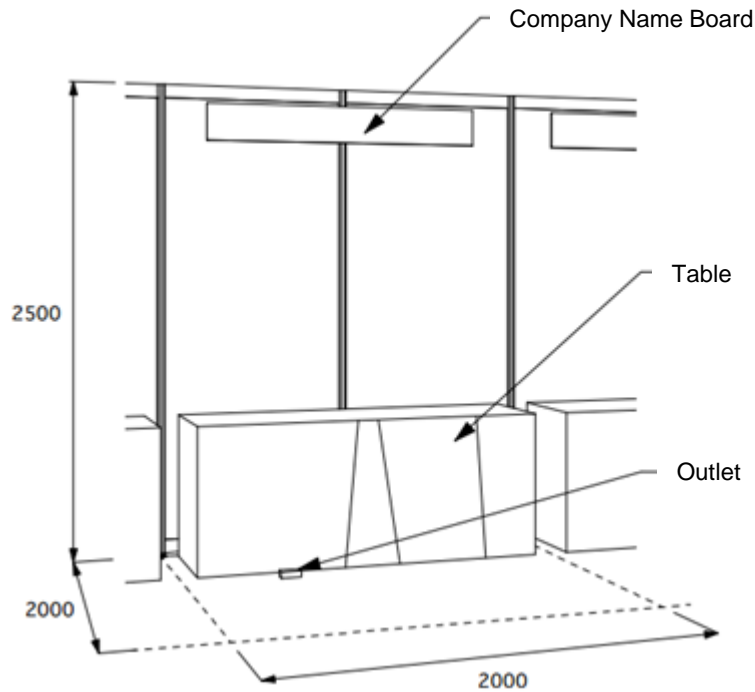

Exhibition Fee includes:

- Back Panel: Width 2m × Height 2.5m
- Table w/ Cloth
- Company Name Board
- Electrical Outlet (100V / 1kW)
- Exhibitor Badge x 2

*If you need more than 2 badges, it is possible for you to purchase.

*Exhibitor badges are not valid for admission to the conference program venue.

*Regarding the place of booth, INTELEC2015 Committee will consider and make decision.
Floor Plan *tentative
Exhibition will be held on the 7th floor of the Swissôtel NANKAI OSAKA.
Rooms Fuyo, Tachibana, Kaede and Hanagiri.

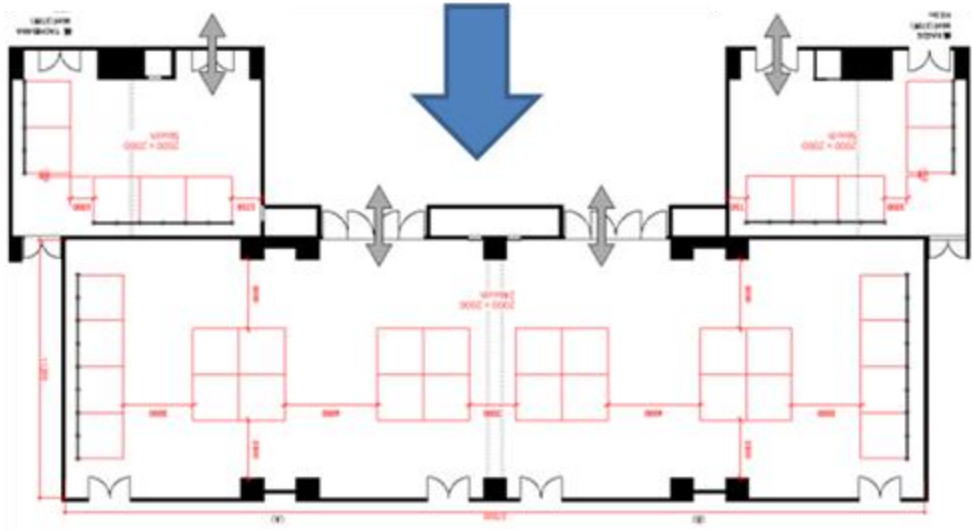
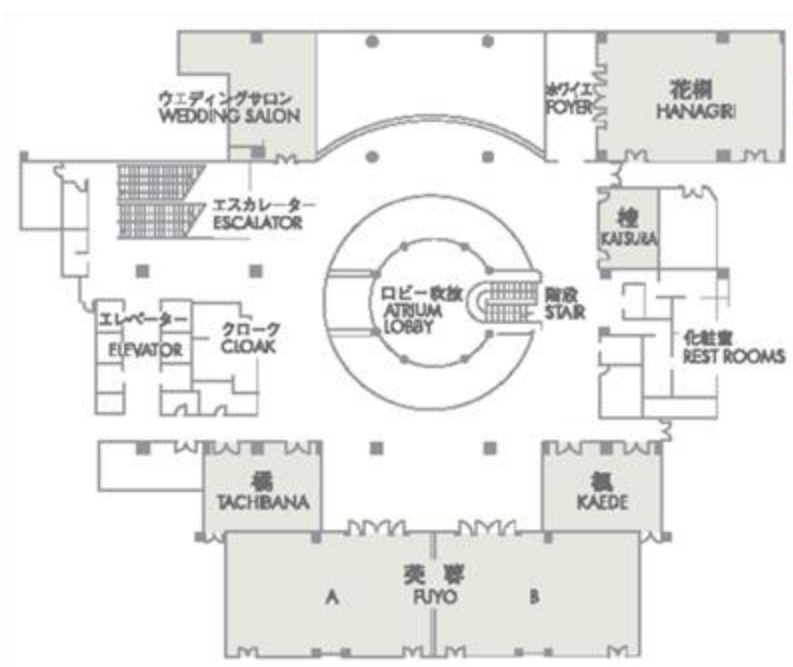
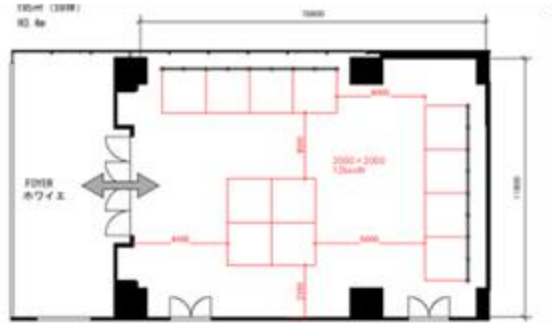

We do not accept cancellation after the application. If you are forced by circumstances to cancel or change the number of booth, please inform us by letter. For this situation, you will be charged cancel fee as shown below.

on or before June 30, 2015	50% of Exhibition Fee
After July1, 2015	100% of Exhibition Fee

Cancellation or Shortening of the Exhibition:

The organizer reserves the right to change the dates and times of INTELEC or to cancel it outright if the site or buildings where the exhibition is to be held become unsuitable for human occupation or in the event that it becomes prohibitively difficult to hold the event due to fire, a natural disaster such as an earthquake or typhoon, epidemic, incident of terrorism, instruction or order from a third party, or other act of god. The INTELEC2015 organizer is not liable for any losses, additional costs, or other disadvantages to which exhibiting companies are exposed as a result of any such decision. Exhibit fees will not be refunded if an act of god occurring during the event forces the event dates or times to be shortened. In the event an act of god occurring before the event is held forces the cancelation of the entire event, exhibit fees will be refunded less necessary expenses for which the organizer may reasonably expect reimbursement.

Application

Please write on the application form and send it to secretariat by e-mail or fax.

Logo (Package sponsor)

1. send your Logo Data along with the application form.

Please submit either high resolution JPEG, or outlined Illustrator data.

2. be noted that the back ground color where the logo will be positioned, is white.

3. be noted that horizontal logo will be used if we receive several types of logos.

In some cases, we may ask you for several logo data from which the Secretariat can choose.

4. notify the URL you wish to link with the uploaded logo. English Website Preferable.

Schedule *tentative

Application Deadline 1	May 31 (early bird rate for exhibition)
Application Deadline 2	June 30
Floor plan and Exhibitors' Manual	August
Submission of Advertisement	August 20
Conference	October 18- 22
Move- in	October 18
Exhibition	October 18- 20
Move- out	October 20 evening

Sponsorship / Exhibition Application Form

Invoice will be sent after we received the application form.

INTELEC2015 Secretariat c/o ICS Convention Design, Inc.

Tel: +81-3-3219-3541 Fax: +81-3-3219-3577E-mail: intelec2015@ics-inc.co.jp

Company Name			
URL			
Address			
Tel		Fax	
Name of the contact person		Mr. / Ms.	
E-mail			
			Amount
Package Sponsorship			
Diamond Sponsor	JPY 5,000,000	x	
Gold Sponsor	JPY 3,000,000	x	
Silver Sponsor	JPY 2,000,000	x	
Bronze Sponsor	JPY 1,000,000	x	
Advertisement on Program Book			
Back Cover	JPY 500,000	x	
Inside Cover	JPY 350,000	x	
Back Matter Color	JPY 250,000	x	
Back Matter B&W	JPY 200,000	x	
Coffee Break			
Coffee Break	JPY 200,000	x	
Insert in Congress Bag			
Insert in Congress Bag	JPY 200,000	x	
Name Badge Straps			
Name Badge Straps	JPY 250,000	x	
Exhibition			
Exhibition	JPY 350,000	x	
			Total
Remarks			

Invoice will be sent after we received the application form.

INTELEC2015 Secretariat c/o ICS Convention Design, Inc.

Tel: +81-3-3219-3541 Fax: +81-3-3219-3577E-mail: intelec2015@ics-inc.co.jp